

- NOTES:**
- ALL DIMENSIONS ARE IN MILLIMETRES, UNLESS OTHERWISE MENTIONED.
  - DIMENSIONS ARE NOT TO BE SCALED, FOLLOW ONLY WRITTEN DIMENSIONS.
  - ALL REINFORCEMENTS SHALL BE  $F_y=500$  CONFORMING TO IS:1786.
  - GRADE OF CONCRETE SHALL BE M40.
  - MINIMUM CLEAR COVER TO ANY REINFORCEMENT SHALL BE 40mm.
  - DEVELOPMENT LENGTH REPRESENTED BY  $L_d$  SHALL BE EQUAL TO 41 TIMES THE DIA. OF THE BAR.
  - LAP LENGTH SHALL BE EQUAL TO 58 TIMES THE DIA. OF BAR AND NOT MORE THAN 50% OF THE BARS SHALL BE LAPPED AT A SECTION.
  - ALL LAPS SHALL BE STAGGERED, NOT MORE THAN 50% OF REINFORCEMENT SHALL BE LAPPED AT ANY SECTION.
  - ADEQUATE LINKS/SPACER BARS SHALL BE PROVIDED FOR PROPER POSITIONING OF REINFORCEMENT.
  - FAR FACE BARS SHOWN THUS NEAR FACE BARS SHOWN THUS
  11. DOWEL BARS FOR RAIL PLINTH, PARAPET WALL AND ONE MAST PEDESTAL SHALL BE LEFT BEFORE CONCRETING.

- REFERENCE DRAWINGS :**
- 022077-BSRP-CR2-C-VD-GEN-30-2362..... GENERAL ARRANGEMENT DETAILS OF 20.75M CURVED SPAN (R=1004.25M) SUPERSTRUCTURE AT BENNIGANAHALLI STATION FOR CR2 FOR BPP1 TO BPP2 - DOUBLE TRACK
  - 022077-BSRP-CR2-C-VD-GEN-30-2363..... REINFORCEMENT DETAILS OF 20.75M CURVED SPAN (R=1004.25M) SUPERSTRUCTURE AT BENNIGANAHALLI STATION FOR CR2 FOR BPP1 TO BPP2-DOUBLE TRACK
  - 022077-BSRP-CR2-C-VD-GEN-30-2364..... PRE TENSIONED STRAND DETAILS FOR 20.75M CURVED SPAN (R=1004.25M) SUPERSTRUCTURE AT BENNIGANAHALLI STATION FOR CR2 FOR BPP1 TO BPP2 -DOUBLE TRACK
  - 022077-BSRP-CR2-C-VD-GEN-30-2391..... MISCELLANEOUS DETAILS DRAWING FOR PRETENSION I-GIRDER

SCHEDULE OF REINFORCEMENT					
ITEM	BAR MARK	BAR DIA.	SHAPE	TOTAL NOS./ SPACINGS	REMARKS
DECK SLAB	11	10		125 c/c	BOTTOM
	11a	10		125 c/c	HAUNCH R/F
	11b	10		3x2 NOS.	HAUNCH R/F
	11c	10		125 c/c	
	12	10		200 c/c	BOTTOM
	13	12		125 c/c	TOP
	13a	10		125 c/c	BUNDLED WITH BAR MARK 13
	14	10		200 c/c	TOP
	15	12		100 c/c	
	15a	12		100 c/c	
DIAPHRAGM	15b	10		100 c/c	
	16	20		4 Nos.	END DIA.
	16a	20		4 Nos.	INTER. DIA.
	17	12		200 c/c	
	17a	12		2x2 NOS.	PER GIRDER
	17b	12		4x2 Nos.	
	17c	12		100 c/c	
	18	12		100 c/c	
	18a	16		3x2x2 Nos.	
	18b	16		1650 1650 760	

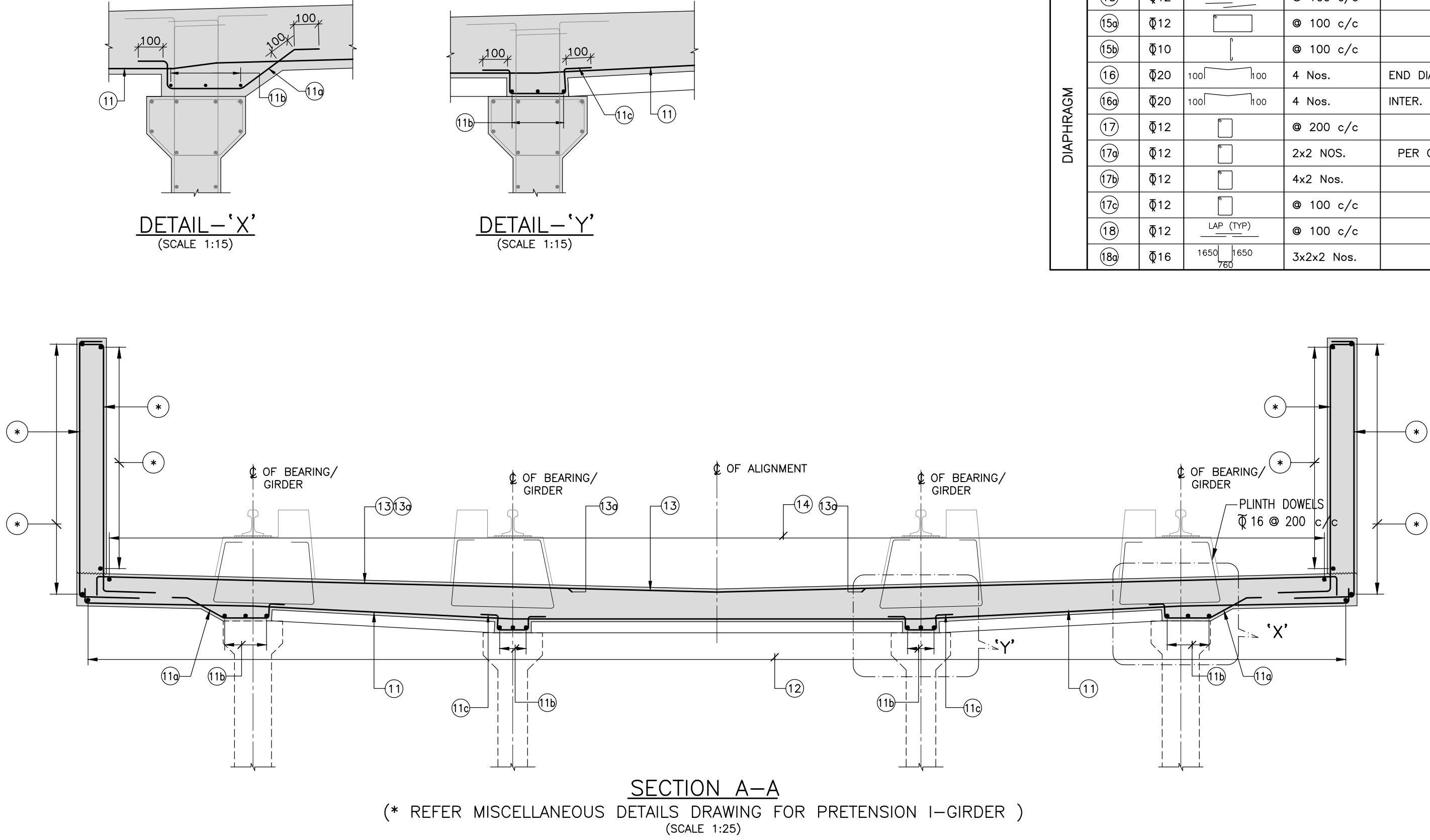
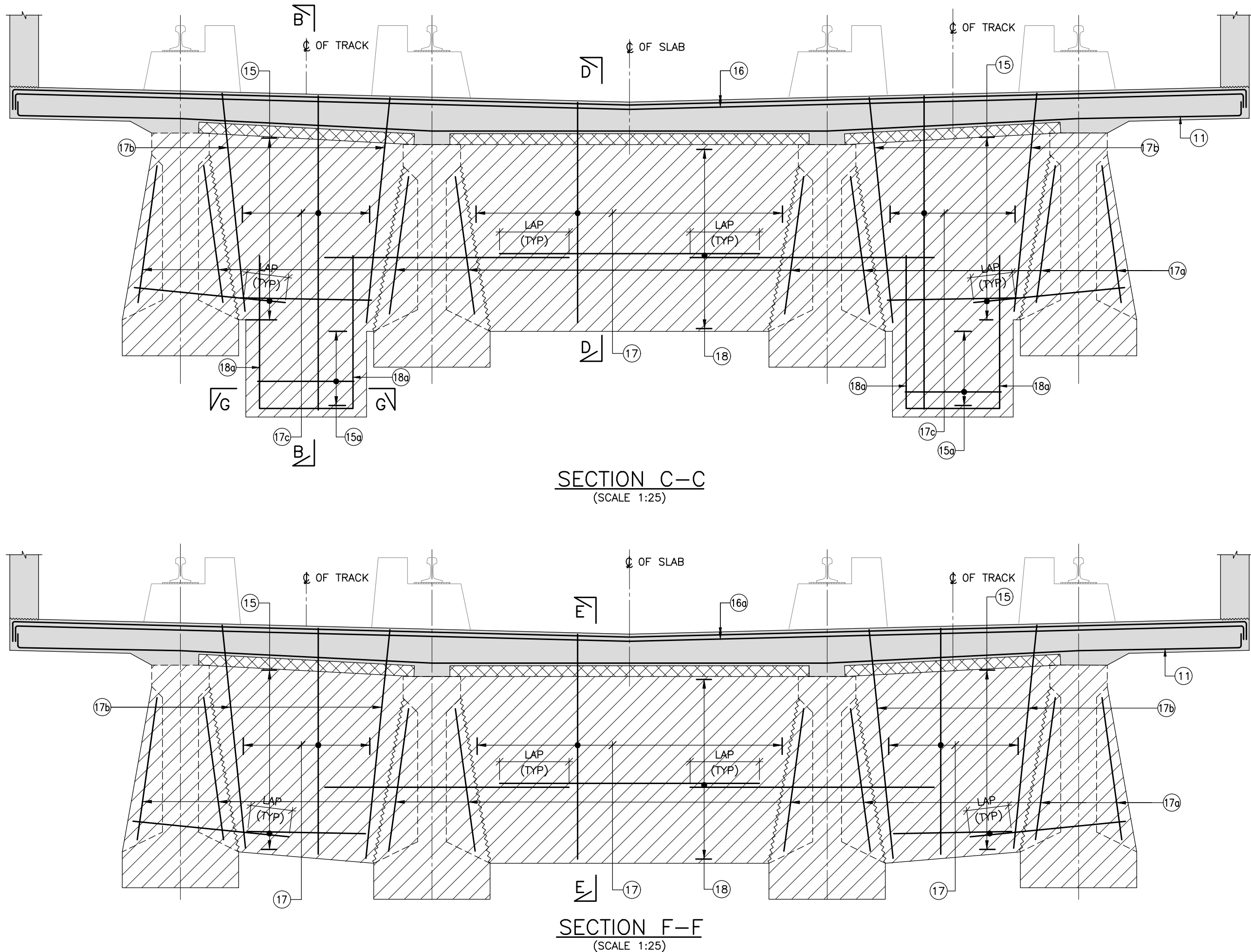

**GOOD FOR CONSTRUCTION**

NOTES :			LEGEND :		REFERENCE DRAWINGS :		REFERENCE DOCUMENTS :		KEY PLAN		STATION BOX KEY PLAN	
			<div><div><div><div><div></div><div>— BEARING</div></div><div><div><div></div><div>— JACKING POSITION</div></div><div><div><div></div><div>— JACKING POSITION</div></div><div><div><div></div><div>— GIRDER</div></div></div></div></div></div></div></div>				DOC—BSRP—CR2—EV—DGN—GEN—30—1352					
REV	DATE	BRIEF DESCRIPTION	CONTRACTOR :		QUALITY ASSURANCE		GENERAL CONSULTANTS		EMPLOYER :		PROJECT :	
			TRANSPORTATION INFRASTRUCTURE IC EDRC-SPECIAL BRIDGES		The responsibility of control, check and verification of accuracy, correctness, completeness, integration and full compliance of Contract provisions in respect of design analysis and drawing rests with Design & Build Contractor.		CHECKED & APPROVED		RAIL INFRASTRUCTURE DEVELOPMENT COMPANY (KARNATAKA) LIMITED		BENGALURU SUBURBAN RAILWAY PROJECT (BSRP) K-RIDE CORRIDOR - 2	
			DETAILED DESIGN CONSULTANT (DDC) :		SIGN		CIVIL/GAD		GENERAL CONSULTANTS :		DRAWING TITLE :	
			an STUP Consultants Pvt. Ltd. P-4, 2nd, Gandhinagar, Mysore 570 004, KARNATAKA Mobile: 9846348484, 9846348484 Tel: 082 2366 6662 Email: anand@stupconsultants.com		PC Contractor		CIVIL ALIGNMENT		K RIDE		REINFORCEMENT DETAILS OF 20.75M CURVED SPAN (R=1004.25M) SUPERSTRUCTURE AT BENNIGANAHALLI STATION FOR CR2 FOR BPP1 TO BPP2 - DOUBLE TRACK (DECK SLAB AND DIAPHRAGM)	
			Indian Institute of Technology Madras IIT P.O., Chennai 600 036 INDIA		DATE		CIVIL/STRUCTURAL		SIGNATURE		DRAWING NO. :	
					26.09.2024		CIVIL/GEOTECH		DATE		O22077-BSRP-CR2-C-VD-GEN-30-2365	
			LAT CONSTRUCTION EDRC-SPECIAL BRIDGES - TIC		NAME				DESIGNATION		REVISION	
					HSS BYM SDC				SIGN		DWG STATUS	
					PREPARED BY				DATE		0	
					CHECKED BY				DATE		C	
					APPROVED BY				DATE		07.06.2024	
					ISSUED BY				DATE		07.06.2024	
0	26.09.24	FOR CONSTRUCTION									SCALE : AS SHOWN	
a	26.07.24	REVISED AS PER GC'S COMMENTS									DATE : 07.06.2024	
b	07.06.24	FOR APPROVAL									SHEET SIZE : A1	